

One Double Bedroom Purpose-Built Flat with PRIVATE GARAGE located close to Walthamstow Central Station

CHURCHILL
estates



St Columbas House, Walthamstow, E17
£1,225 Per Calendar Month



To view call **0208 503 6060**
Email walthamstow@churchill-estates.co.uk



Available Now - UNFURNISHED - Churchill Estates are pleased to offer this One Double Bedroom Purpose-Built Flat with PRIVATE GARAGE located close to Walthamstow Central Station, Local Bus Routes & Market with Walthamstow Village and Wood Street Station also accessible. The property benefits from double glazing, electric heating, modern kitchen with appliances, modern bathroom, communal car parking and security entryphone system. Early Viewings Advised.

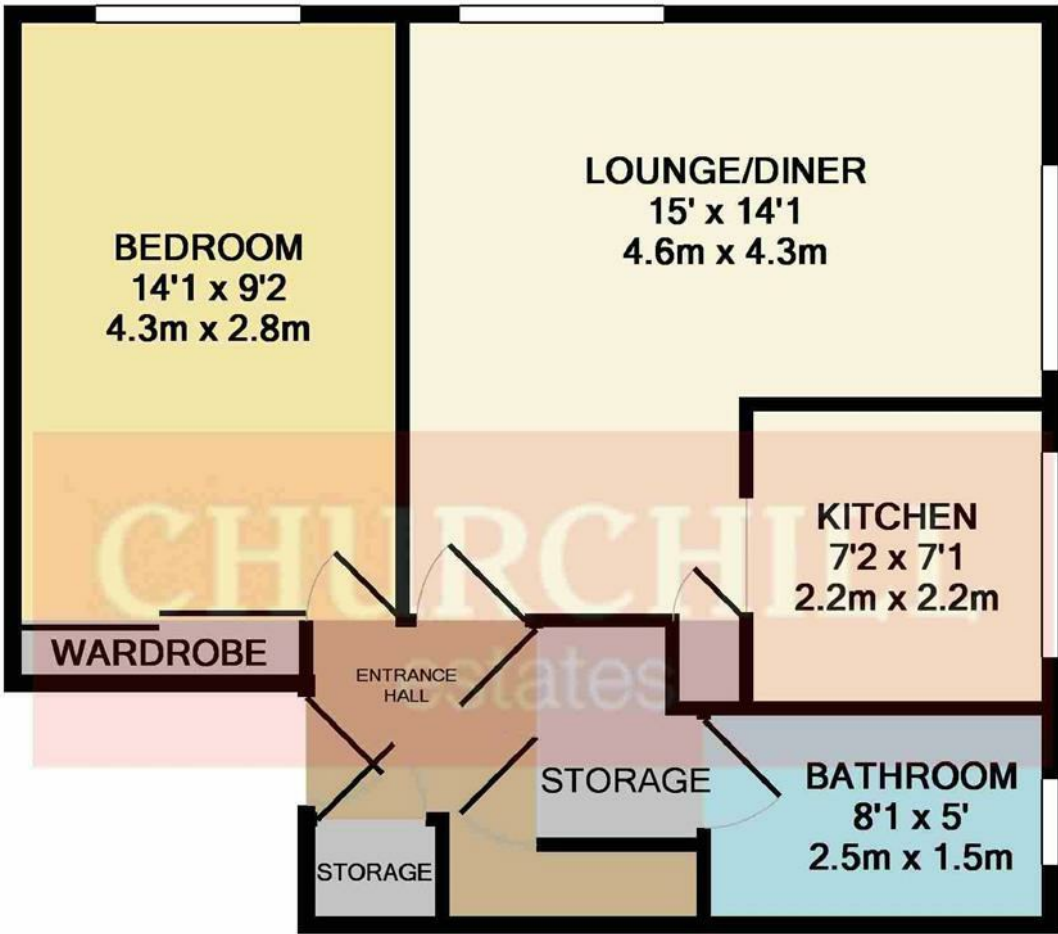

TOTAL APPROX. FLOOR AREA 467 SQ.FT. (43.3 SQ.M.)

Whilst every attempt has been made to ensure the accuracy of the floor plan contained here, measurements of doors, windows, rooms and any other items are approximate and no responsibility is taken for any error, omission, or mis-statement. This plan is for illustrative purposes only and should be used as such by any prospective purchaser. The services, systems and appliances shown have not been tested and no guarantee as to their operability or efficiency can be given
Made with Metropix ©2017

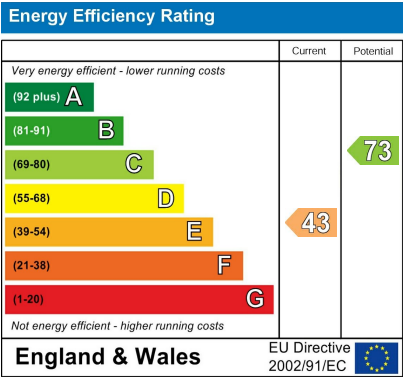
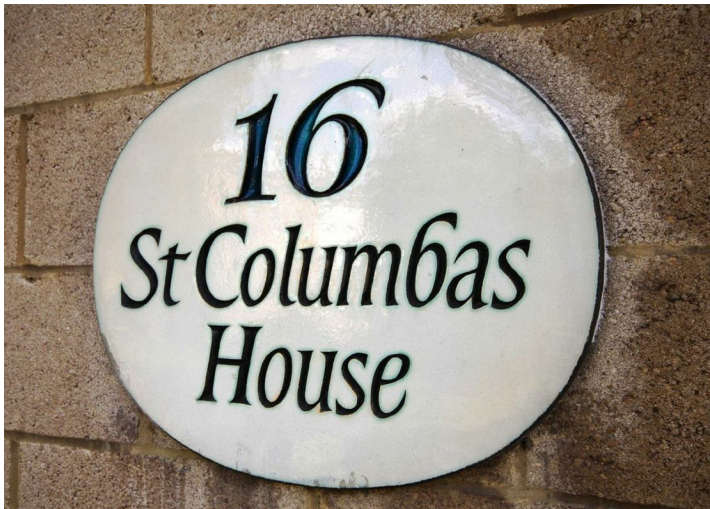

5 week security deposit £1,413

12 month minimum tenancy (6 month break clause may be available)

EPC rating - E

Council Tax Band - B

The Agent has not tested any apparatus, equipment, fixtures and fittings or services and so cannot verify that they are in working order or fit for the purpose. A buyer is advised to obtain verification from their solicitor or surveyor. References to the tenure of a property are based on information supplied by the seller. The agent has not had the sight of the title documents. A buyer is advised to obtain verification from their solicitors.

CHURCHILL
estates

To view call **0208 503 6060**
Email walthamstow@churchill-estates.co.uk